

The Nova Series

TASKalfa MZ10500i & MZ9500ci Series

- + A3 color or black and white copy, print, scan, and optional fax in one device
- + Print speeds up to 105 ppm B&W and 80 ppm Color
- + Up to 300 ipm AI-enabled straight path scanning
- + 2400 x 2400 DPI with integrated ICC profiles
- + Dual toner container system for uninterrupted printing



The Nova Series delivers professional results for complex print and scan jobs. Featuring advanced workflow capabilities, dependable performance, and consistent color output, these devices enhance operational efficiency and cost management.



Consistency that benefits the bottom line

Deliver stable output with built-in ICC color profiles and automatic calibration technology, supporting long runs and minimizing reprints.



Smarter workflow integration

Fiery® and the Kyocera Production Print Suite (KPPS) make handling large print runs simple, ensuring color accuracy, easy job management, and reduced costs.



Efficiency that supports sustainability

Empower users to operate responsibly through actionable CO2 and energy-use insights paired with sustainable toner-control technology.



Sharper, clearer color

Advanced toner formulation and ceramic-based image processing technology work together to deliver bright, vivid prints with exceptional clarity.



Strong protection for sensitive work

Advanced security keeps information safe throughout capture, routing, and output.



Uninterrupted print to reduce downtime

Industry-first dual toner container system and high paper capacity keep moving, reducing downtime.

Color or Black and White	Brand/Family TASKalfa	Product Type M = MFP	Product Format Z = A3	B&W Print Speed (ppm)	Color Print Speed (ppm)	Version	Functionalities/ Identifier (c) Color (i) HyPAS-enabled
Color	TASKalfa	M	Z	75/85/95	70/75/80	00	ci
Black and White	TASKalfa	M	Z	75/85/95/105	-	00	i

Product Configuration: Nova Series at a Glance

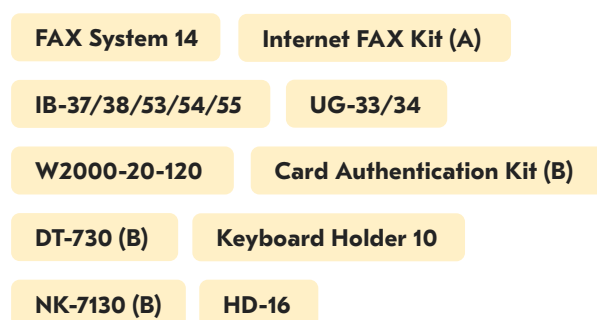
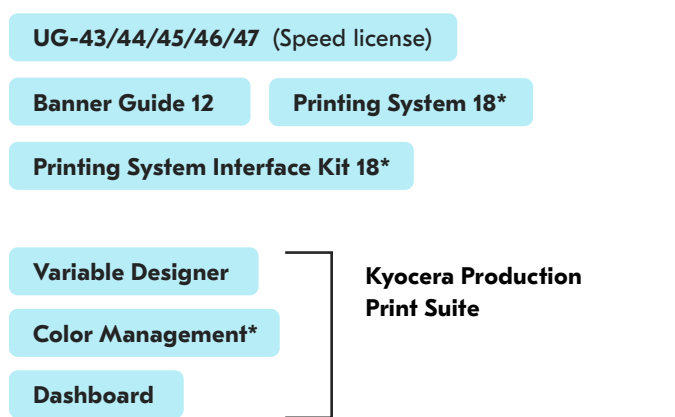
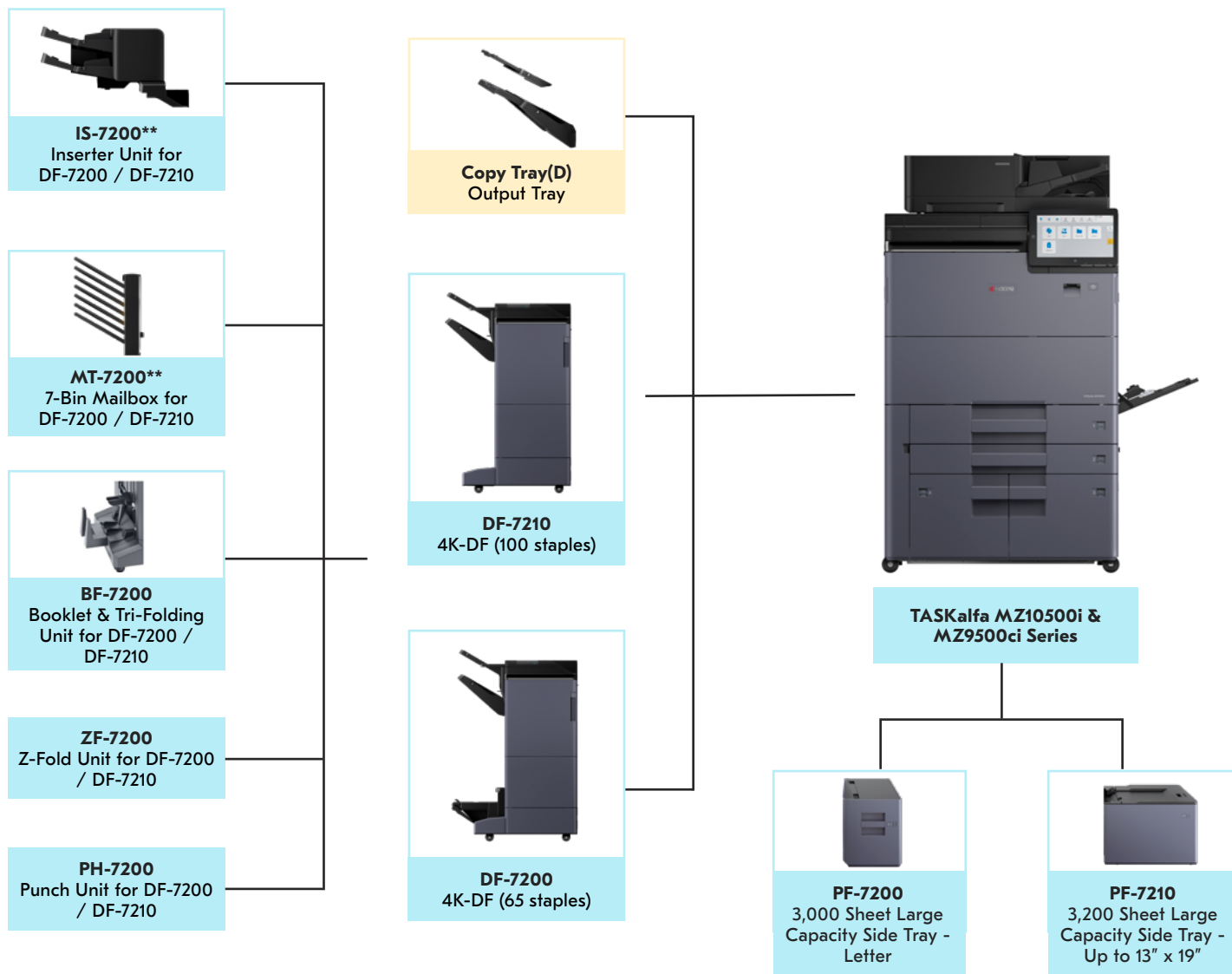

Configure your Nova Series device!

For more details on how to configure your device to match the needs of your office, navigate to our product configurator. The tool aims to pair you to the device configuration* that fits your specific business needs.

Scan or click the QR codes on this page to discover the solutions for you.



Integration with Kyocera solutions

Features		KCC	KCIM	KCPS	DMConnect	PinPoint Scan 3
Document Capture	Capture, classify, process, and route documents to on-prem/cloud storage, DMS, ECM, and ECM	●			●	●
Connect to Cloud Storage	Not only send scanned documents but process them before sending to cloud storage	●		●		
Document Management	A DMS includes features such as version control, document indexing, search, and secure access control to enhance security and productivity.		●			
Print Management	Streamline and optimize printing activities by managing print jobs, controlling costs, tracking output, and enhancing security.			●		

Kyocera Cloud Capture (KCC)



Kyocera Cloud Print and Scan (KCPS)



Kyocera Cloud Information Manager (KCIM)



DMConnect



PinPoint Scan



*Kyocera Document Solutions does not warrant that any specifications mentioned will be error-free. Specifications are subject to change without notice. All other brand and product names may be registered trademarks or trademarks of their respective holders and are hereby acknowledged.

MAIN UNIT

Type:

MZ7500i: 75ppm B&W

MZ8500i: 85ppm B&W

MZ9500i: 95ppm B&W

MZ10500i: 105ppm B&W

MZ7500ci: 75ppm/70ppm Color

MZ8500ci: 85ppm/75ppm Color

MZ9500ci: 95ppm/80ppm Color

Functions: Standard: Print, Copy, Scan;

Optional: Fax

Control Panel: 10.1" Color Touch Screen

Memory: MZ7500i/MZ8500i/MZ9500i/

MZ10500i: 7 GB

MZ7500ci/MZ8500ci/MZ9500ci: 9 GB

Solid State Drive/Hard Disk Drive: Standard:

256 GB SSD; Optional: 1 TB HDD

Interface Connection: Network: 1000Base-

T/100BaseTx/10BASE-T (IPv6, IPv4, IPSec)

Supporting 802.3az; Other Standard: USB 2.0

(Hi-Speed USB), USB 3.0 (Super-Speed USB)

Paper Capacity: Standard: 4,350 Sheets;

Maximum: 7,550 Sheets

Paper Sources: Standard: (2) 550-Sheet Trays,

(2) 1,500-Sheet Decks, (1) 250-Sheet MPT;

Optional: (1) 3,000-Sheet Large Capacity A4

Side Deck, (1) 3,200-Sheet Large Capacity A3

Side Deck

Finishing Capabilities: 4,000 Sheets Finisher

(65-Sheet Staple), 4,000 Sheets Finisher

(100-Sheet Staple), 2 to 4 Hole Punch, Booklet

Unit, Z-Fold Unit, Inserter Unit, 7-Bin Mailbox

Unit (Mailbox and inserter cannot be installed at the same time)

Supported Media Types: Plain, Recycled,

Coated, Thick, Thin, Label, OHP transparency

film, Index tab divider, Envelope, Banner

Supported Media Sizes: 5.5" x 8.5" to 13" x

19.2"; Banner Size up to 13" x 48"

Paper Weight: 14 lb. Bond – 170 lb. Index

(52 - 300 gsm)

Print Speed (B&W and Color):

MZ7500ci: Up to 75ppm B&W/70ppm Color

Letter, 45ppm B&W/42ppm Color Legal,

37ppm B&W/35ppm Color Ledger, 26ppm

B&W/24ppm Color 13"x19.2"

MZ8500ci: Up to 85ppm B&W/75ppm Color

Letter, 51ppm B&W/45ppm Color Legal,

42ppm B&W/37ppm Color Ledger, 29ppm

B&W/26ppm Color 13"x19.2"

MZ9500ci: Up to 95ppm B&W/80ppm Color

Letter, 57ppm B&W/48ppm Color Legal,

47ppm B&W/40ppm Color Ledger, 33ppm

B&W/28ppm Color 13"x19.2"

Print Speed (B&W):

MZ7500i: Up to 75ppm Letter, 45ppm Legal,

37ppm Ledger and 26ppm 13" x 19.2"

MZ8500i: Up to 85ppm Letter, 51ppm Legal,

42ppm Ledger and 29ppm 13" x 19.2"

MZ9500i: Up to 95ppm Letter, 57ppm Legal,

47ppm Ledger and 33ppm 13" x 19.2"

MZ10500i: Up to 105ppm Letter, 63ppm Legal,

52ppm Ledger and 36ppm 13" x 19.2"

Warm Up Time:

MZ7500ci, MZ7500i, MZ8500i, MZ9500i:

30 sec or less

MZ8500ci: 45 sec or less

MZ10500i: 50 sec or less

MZ9500ci: 60 sec or less

Dimensions (W x D x H): Approximately 27.0"

x 26.0" x 48.3" (686mm x 660mm x 1,227mm)

for all models

Weight:

MZ7500ci, MZ8500ci, MZ9500ci:

363.8 lbs (165 kg);

MZ7500i, MZ8500i, MZ9500i, MZ10500i:

335.1 lbs (152 kg)

PRINT SPECIFICATIONS

Print Resolution:

MZ7500i/MZ8500i/MZ9500i/MZ10500i:

Up to 1200 x 1200 dpi

MZ7500ci/MZ8500ci/MZ9500ci:

Up to 2400 x 2400 dpi

PDLs/Emulations:

MZ7500ci, MZ8500ci, MZ9500i:

PCL6 (PCL XL/PCL 5c);

MZ7500i, MZ8500i, MZ9500i, MZ10500i:

PCL6 (PCL XL/PCL 5e);

PRESCRIBE, KPDL3 (PostScript3 compatible)

AES Support, PDF, XPS/OpenXPS, PPML

Image Formats: TIFF, JPEG, URF, PWG Raster,

PCLm

Mobile Devices & Cloud Ready Printing:

Apple AirPrint®, Mopria®, KYOCERA Mobile

Print, KYOCERA MyPanel, KYOCERA Print

Service Plug-in

Fonts: 93 Fonts (PCL6), 136 Fonts (KPDL3), 4

Fonts (Calibri), 4 Fonts (Cambria), 1 Font Bitmap

font, 79 Outline fonts

Operating Systems: Windows: 10/11; Server

2016/Server 2019/Server 2022/Server 2025;

Mac OS X v10.0 or later; Chrome OS

COPY SPECIFICATIONS

First Copy Out Time:

3.7 seconds or less (B&W)

5.0 seconds or less (Color)

Copy Resolution: 600 dpi x 600 dpi

Continuous Copy: Up to 1,001 as standard,

up to 9,999 with HDD installed

Magnification (Manual Mode): 25% to 400%,

1% increments

SCAN SPECIFICATIONS

Scan Type: Color and Black & White Scanner

Document Processor: 500-Sheet Standard Dual

Scan Document Processor with Straight Path

Scanning

Original Size: Up to 11" x 17"

File Formats: TIFF (MMR compression), JPEG,

XPS, OpenXPS, PDF (MMR compression), PDF

(JPEG compression), PDF (High compression),

Searchable PDF, MS Office file"

Document Processor Speed: Simplex: 150 ipm,

Duplex: 300 ipm

m), Banner: (297 x 1,600mm)

Cloud Ready Services: Kyocera Cloud Capture

(KCC), Kyocera Cloud Information Manager

(KCIM), Kyocera Cloud Print and Scan (KCPS))

Resolution: Up to 1200 x 1200 dpi

Cloud Ready Services: Kyocera Cloud Capture

(KCC), Kyocera Cloud Information Manager

(KCIM), Kyocera Cloud Print and Scan (KCPS)

Resolution: Platen Glass: 600 dpi x 600 dpi,

Document Processor: 600 dpi x 600 dpi /

600 dpi x 300 dpi

Drivers: TWAIN/WIA/WSD Scan

OPTIONAL FAX SPECIFICATIONS

ModFax Type: Fax System 14 (option)

Modem Speed: G3: 33.6kbps

Compression Method: G3 Fax/MMR, MR, MH,

JBIG

Fax Memory: Standard 170 MB

Driver: Network Fax Driver

Transmission Time: Less than 3 seconds/33.6

Kbps

Fax Functions: Network Fax, Duplex

Transmission and Reception, Encrypted

Transmission and Reception, Polling

Transmission and Reception, Broadcast, Fax

Server Integration, Fax Dedicated Paper Feed

Tray, Fax Forwarding to email or file

SECURITY SPECIFICATIONS

Guarded Access: LDAP, IP Filtering, Secure

Print Release, SMTP Authentication, Create

Encrypted PDF, Card Authentication

Protected Data Storage: HDD Overwrite,

Trusted Platform Module, IEC-15408 Common

Criteria, IEEE 2600 Certified, HCD-PP Certified

Secure Communication: TLS v1.3, SMB 3.1.1,

HTTPS, ECDSA, FIPS 140-3 Encryption, S/

MIME, IPSec with HCD-PP, IPPS Printing (Over

TLS), SCEP Certificated Enrollment, OSCP/CRL

Certificates, 802.1X Ethernet Certificates

Advanced Management: 3 Preset Security

Level Configurations, Remote Management

of Fleet, SNMP v3 Monitoring, SIEM/Syslog

Monitoring, Secure Boot Check, Run Time

Integrity Checks, Allow List

TASKalfa MZ10500i & MZ9500ci Series

ENVIRONMENTAL SPECIFICATIONS

Operating Environment: Temperature: 50 F - 90.5 F (10 - 32.5°C); Humidity: 10 - 80% RH (Relative Humidity)

Power Requirements: 120V: 60Hz, 18.5A; 220-240V, 50/60Hz, 10A

Sleep Mode: 0.5W

Standard: Energy Star Certified

Typical Electricity Consumption (TEC)

Rating:

MZ7500ci: 1.50 kWh/week (120V); 1.45 kWh/week (220-240V)

MZ8500ci: 1.76 kWh/week (120V); 1.62 kWh/week (220-240V)

MZ9500ci: 1.91 kWh/week (120V); 1.79 kWh/week (220-240V)

MZ7500i: 1.39 kWh/week (120V); 1.34 kWh/week (220-240V)

MZ8500i: 1.55 kWh/week (120V); 1.51 kWh/week (220-240V)

MZ9500i: 1.75 kWh/week (120V); 1.74 kWh/week (220-240V)

MZ10500i: 1.95 kWh/week (120V); 2.02 kWh/week (220-240V)

CONSUMABLES

Toner:

MZ7500i, MZ8500i, MZ9500i & MZ10500i:

TK-6837

MZ7500ci, MZ8500ci & MZ9500ci:

TK-8837C/M/Y/K

Black & White MFPs:

Toner Capacity: 40,000 Pages - (1) TK-6837

Machine Capacity: 80,000 Pages - (2) TK-6837

Color MFPs:

Black Toner Capacity: 42,500 Pages - (1)

TK-8837K;

Black Machine Capacity: 85,000 Pages - (2)

TK-8837K;

Color Toner Capacity: 24,000 Pages - (1)

TK-8837C/M/Y;

Color Machine Capacity: 48,000 Pages - (2)

TK-8837C/M/Y

*Color is estimated at 5% coverage.

B&W is estimated at 6% coverage.

Black and White

TASKalfa MZ7500i

75 ppm



TASKalfa MZ8500i

85 ppm



TASKalfa MZ9500i

95 ppm



TASKalfa MZ10500i

105 ppm



Color

TASKalfa MZ7500ci

75 ppm B&W
70 ppm Color



TASKalfa MZ8500ci

85 ppm B&W
75 ppm Color



TASKalfa MZ9500ci

95 ppm B&W
80 ppm Color



Meet the Nova Series here:



DS Business Life Simplified
COPIER TEAM

New Jersey Office (HQ)

151 Sumner Avenue

Kenilworth, NJ 07033

908.653.0600

New York Office

30 Wall Street

New York, NY 10005

212.468.5200

www.dsbls.com

kyoceradocumentsolutions.us/nova

Kyocera Document Solutions does not warrant that any specifications mentioned will be error-free. Specifications are subject to change without notice. Information is correct at time of going to press. All other brand and product names may be registered trademarks or trademarks of their respective holders and are hereby acknowledged.

©2026 KYOCERA Document Solutions America, Inc.